



# CHES Replacement Project

**Implementation & Transition  
Webinar**

30 June 2021

# Housekeeping: trouble shooting

- Check your system requirements
- Audio options:
  1. Use your computer's mic and speakers ("Computer audio"). Check that your computer's audio is unmuted
  2. Use a telephone to dial in ("Phone call")
    - Phone number: **+61 2 9087 3602**
    - Access code: **177-592-358**
    - No need to enter an Audio PIN as audience is muted
  3. If you are still experiencing audio difficulties, try downloading the GoTo Webinar Application on your smart phone, and enter the Webinar ID: **800-443-051**

Further information:

<https://support.goto.com/webinar/how-to-join-attendees>

GoToWebinar Attendee System Check for Webcast Webinars

**Looks good! You can join a webinar.**



- ✔ OS - Windows 8.1
- ✔ Browser - IE 11
- ✔ Internet connection - Strong
- ✔ Flash - Enabled

Test your system again

View System Requirements

Next steps

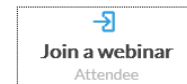

# Housekeeping: how to submit questions

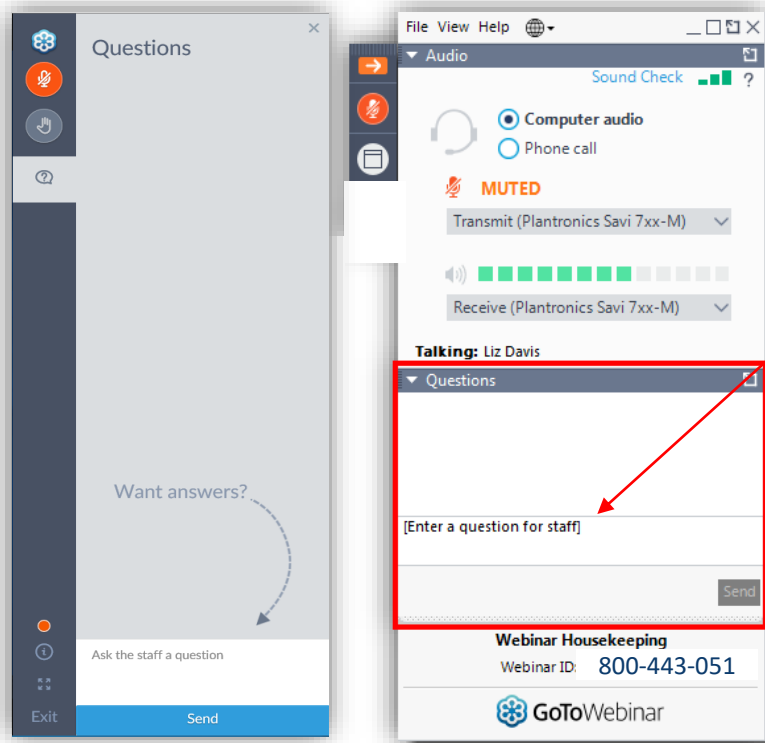

## Your Participation

- To submit your text questions and comments use the Questions panel
- Note that your questions will not be seen by other attendees

For more information - refer to the webinar tips published on the ASX [CHES Replacement web page](#)

# Agenda

- 
- Project update
- 
- Industry test strategy
- 
- Q&A
- 
- Next steps
-

# Presenters and introductions

- 
- **Keith Purdie** - Senior Manager, Equity Post Trade Services
- 
- **Triona Quinlan** - Implementation Program Manager, Delivery
- 
- **Jason Genford** - Project Manager, Equity Post Trade Services
- 
- **Fraser Moodie** - Senior Manager, Integration and Connectivity, Equity Post Trade
- 
- **Nick Heffernan** - Senior Manager, Customer Readiness, Clearing Settlement Ops
-

# Project Update

# Project update

June 2021

- > The following documents have been published earlier today:
  - Response to consultation feedback on the confirmed changes to netting and settlement workflows
  - Updated functional specifications and messaging requirements for netting and settlement workflows
  - Industry test strategy information paper
- > CDE infrastructure upgrade now complete
- > Concluded the initial engagement with CHES users on CHES Registration migration exceptions
- > Restructure of the documentation portal in preparation for the next phase of the project
- > Corporate actions STP phase 2 go-live on 5 June
  - Project details, scope of changes and phases –  
[www2.asx.com.au/markets/clearing-and-settlement-services/asx-settlement/corporate-actions-stp](http://www2.asx.com.au/markets/clearing-and-settlement-services/asx-settlement/corporate-actions-stp)
  - Real time corporate actions service –  
[www2.asx.com.au/connectivity-and-data/information-services/reference-data/real-time-corporate-actions](http://www2.asx.com.au/connectivity-and-data/information-services/reference-data/real-time-corporate-actions)

# Customer-facing Documentation Update

## Documentation Portal Restructure

- > June includes publication of netting and settlement workflow changes (for code release in CDE10) and the Industry Test Strategy.
- > The documentation portal has been restructured in advance of industry testing.
- > Key changes include:
  - CDE testing information is now under the Implementation Phases chapter, along with environment details for ITE1 and beyond; and
  - Cutover and Migration information has been given its own chapter.
- > There are no changes to the structure of existing functional / messaging specifications.
- > Existing pages that duplicate content within the Industry Test Strategy will be archived. All other pages, including any existing bookmarks to these pages will remain valid.



Testing



Environments



Implementation Phases



Cutover and Migration



# Section 1 – Introduction to industry test strategy

# S.1 - Industry Test Strategy

## Introduction

- > The Industry Test Strategy paper is available as online confluence pages and as an Adobe PDF document
- > The paper has been structured as follows:
  - Section 1 – Introduction to the industry test strategy
  - Section 2 – Industry testing overview and timeline
  - Section 3 – Software provider readiness test phases
  - Section 4 – CHES user readiness
  - Section 5 – Industry test environments
  - Section 6 – Documentation release plan
  - Section 7 – Summary of industry testing

# S.1 - Industry Test Strategy

## Purpose of industry test strategy

- > Inform software providers and CHES users on the industry testing approach
- > Provide a breakdown on the different test stages and industry test environments
- > Communicate what testing and evidence is required from software providers and CHES users
- > Detail a forward work plan for ASX providing additional supporting documentation
- > Help software providers and CHES users prepare for and resource their testing plans

# Section 2 – Industry testing overview and timeline

# S.2 - Industry testing overview & timeline

## Overview of industry testing stages

- > Industry testing comprises of two key stages:
  1. **Software provider readiness** - where software providers (i.e. vendors and those developing in-house systems) are able to undertake functional and non functional testing and complete technical accreditation. Software provider readiness testing will primarily occur in Industry Test Environment 1 (ITE1)
    - There are two distinct phases for software providers in ITE1, system testing (including performance testing) and technical accreditation
  2. **CHES user readiness** - where CHES users test their systems and conduct operational readiness. CHES user readiness testing will primarily occur in Industry Test Environment 2 (ITE2)
    - There are three distinct phases for CHES users in ITE2, (1) user testing (including performance testing) (2) operational readiness and (3) industry wide testing (IWT)
- > **Inflight migration testing** is a separate phase of testing, which will take place in a separate and dedicated environment called the '**Industry Test environment Migration**' (ITE-M)
  - ITE-M will be available for both software providers and CHES users during dedicated periods to functionally test workflows that will be inflight at the point of migration

# S.2 - Industry testing overview & timeline

## Industry Testing Timeline

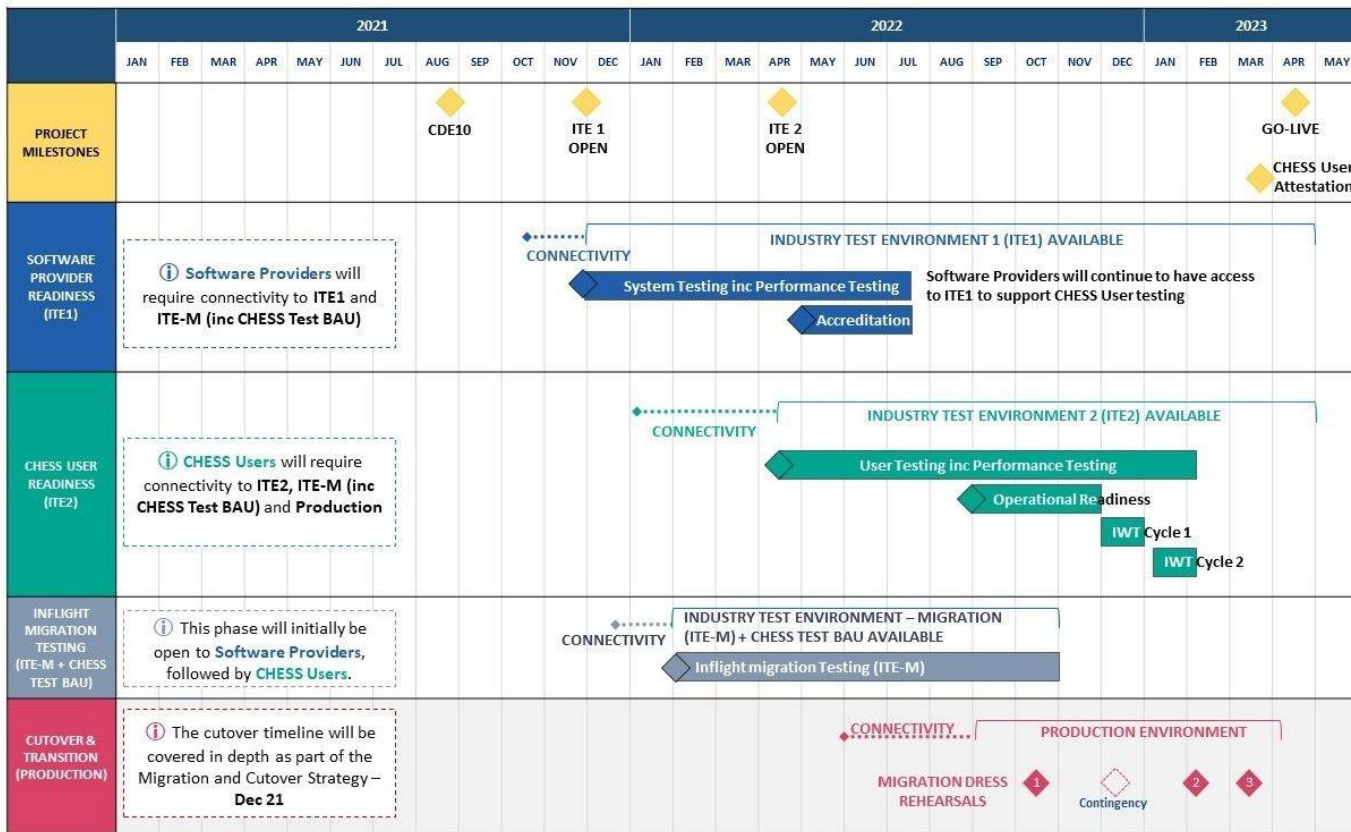

### Upcoming Key documentation milestones

- > Industry Test Strategy – Jun 21
- > Connectivity Guide ITE1 –Jul 21
- > Guide to Testing Services – Aug 21\*
- > Connectivity Guide ITE-M – Sep 21
- > Accreditation Guide – Nov 21
- > Connectivity Guide ITE2 – Sep 21
- > Ops Readiness Scenarios – Dec 21

\*The Guide to Testing Services will be published to provide software providers and CHESSTest users the next level of detail to enable organisations to plan and execute all relevant phases of industry testing.

The forward release plan will continue to be updated highlighting when key deliverables and topics will be published to the market

# Section 3 – Software provider readiness test phases

## S.3 – Software provider readiness

### Overview

- > Software providers refer to third party vendors who supply software to CHESSE users or to those CHESSE users that develop software in-house – access to ITE1 is provided to software providers only
  - Key vendors provide software to the majority of CHESSE users in current CHESSE. Vendors will continue to provide systems to the majority of the CHESSE users in the replacement system
- > Third party vendors develop software for a range of CHESSE users, providing them solutions to use as either:
  - An interface solution between CHESSE and a CHESSE users' own internal system(s); or
  - A full back office solution that supports both the processing and an interface to CHESSE.

To date software providers have been able to develop and functionally test their software in CDE. They will move to ITE1 once they have completed their development. ITE1 provides software providers additional scope for functional testing, as well as the ability to test non-functional items not available in CDE



# S.3 – Software provider readiness

## Phases of Software Provider Readiness Testing

- > Software provider readiness is a stage where software providers have the ability to perform functional and non-functional testing on all functionality
- > Software provider readiness testing can be categorised by three main phases:
  - System testing, including performance testing
  - Inflight migration testing
  - Accreditation

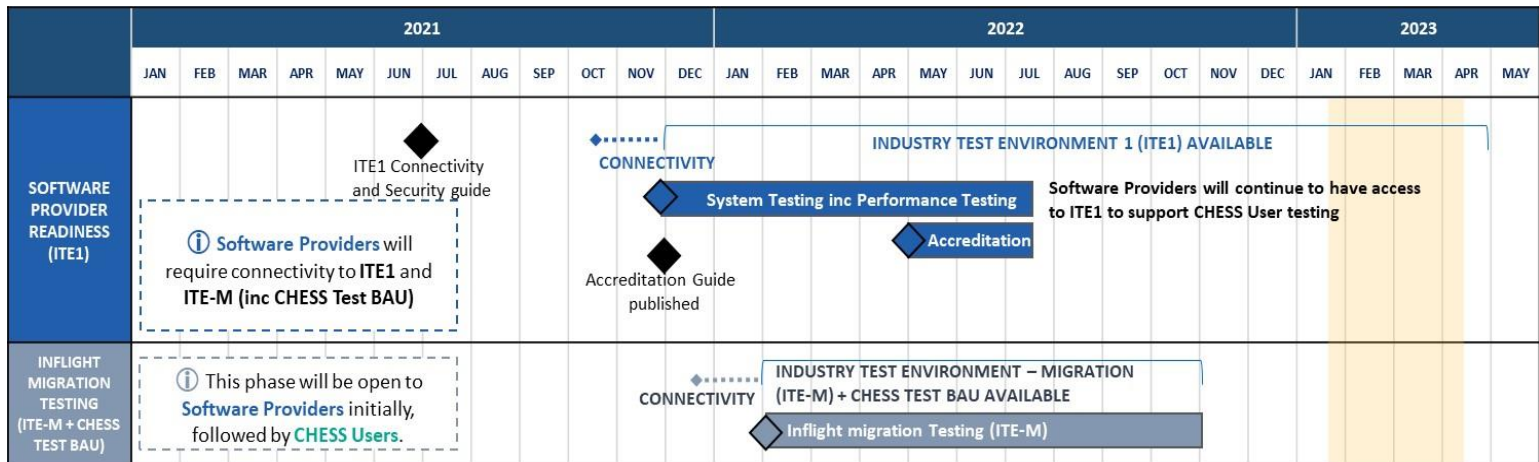

# S.3 – Software provider readiness

## System Testing

### Purpose

- > The objective of system testing is to enable software providers to complete all functional and non functional testing of software solutions in a performant production-like environment
  - System testing, including performance testing, will be performed in ITE1

### How will this phase of testing be run?

- > System testing in ITE1 will be open to software providers to test with flexibility. ASX will not mandate a test schedule, but will provide the necessary tools for each organisation to test independently
- > To allow software providers the ability to test without the dependency of others they will be allocated their own unique CHES test kit (similar to the current CHES test kits today)
- > Each kit will contain a list of dedicated UICs and a unique set of test securities that will allow developers to test any CHES role, which will allow a software provider to play the counterparty in multi-party scenarios and also allow them to test all workflow

# S.3 – Software provider readiness

## Test Tools

### How will this phase of testing be run?

- > ASX will make available a number of client test tools to assist software providers with their testing
- > Software providers will need to test all workflow associated with the CHES user type their software is being designed to support
- > ASX will also run scheduled failover events during system testing to ensure the software developed manages these incidents appropriately

### External Entry Criteria

- > Software providers are required to have completed all solution development on CDE

### Critical Success Factors

- > Software providers are required to run all scenarios related to accreditation scope to prove readiness

## S.3 – Software provider readiness

### Performance testing

- > ASX will provide software providers and CHES users the option and the necessary tools to performance test solutions developed and corresponding interfaces during the system test and CHES user test window
  - Industry performance testing is not a mandatory phase of testing that ASX will evidence
- > Industry performance testing aims to test the speed, response time, stability, reliability, scalability and resource usage of a software application under workload. It will allow software providers and CHES user the ability to:
  - Test the performance of their interfaces with the CHES replacement system
  - Obtain volume metrics on how their systems interact with each of the interface points - AMQP, FIX, Ledger API
- > Software providers or CHES users will need to advise and plan for performance testing
- > Software providers (or CHES users) will need to demonstrate stability in ITE for a period of time prior to ASX releasing performance test tools or supporting performance test windows

## S.3 – Software provider readiness

### Inflight Migration Testing

#### Purpose

- > To allow software providers and CHES users the ability to test workflow that starts in current CHES and completes in the CHES replacement system
  - For example, a trade registered in CHES on the Friday before cut-over weekend will settle in the CHES replacement system. It will also support the ability to modify data in CHES that has been migrated to CHES replacement (e.g. accounts and holdings)

#### Where will inflight testing be conducted?

- > ASX will introduce two new environments - a CHES BAU environment (for source data) and Industry Test Environment - Migration (ITE-M) – to support this phase of testing

#### How will this phase of testing be run?

- > ASX will populate the CHES BAU environment with UICs, security reference data and corporate events
- > Software providers or CHES users will then enter their own data of accounts, holdings and settlement obligations
- > Based on a schedule to be provided, ASX will migrate all of this data into the new ITE-M environment. Software providers or CHES users will have the opportunity to access the data for subsequent workflow or to create updates

# S.3 – Software provider readiness

## Inflight Migration Testing

### How will this phase of testing be run? (cont.)

- > This phase will be open only to software providers initially. CHESSE users will be provided access at a later point during the phase

### External Entry Criteria

- > Software providers or CHESSE users will be required to have sufficiently mature solutions and to have undertaken testing prior to this phase. ASX will provide guidance around these expectations prior to ITE1 and ITE-M open

### Critical Success Factors

- > Software providers or CHESSE users to complete functional scenarios associated with inflight workflows

Inflight Migration Testing is not a mandatory phase of testing. However, it is expected that all software providers who provide clearing and settlement software complete this phase.

# S.3 – Software provider readiness

## Technical accreditation

### Purpose

- > Accreditation is a formalised process, with the objective of ensuring all systems that connect to an ASX platform conforms to both the functional and non-functional requirements of ASX
  - Accreditation is a mandatory requirement for all systems connecting to the CHES replacement production environment and software providers are responsible for performing accreditation
  - Technical accreditation is not intended to demonstrate a host system is functionally compliant with CHES replacement end to end workflow (this is covered by operational readiness testing)

### Where will Accreditation be conducted

- > Accreditation will be undertaken in ITE1 following the system test phase

### How will this phase of testing be run?

- > Accreditation will cover connectivity and messaging with the CHES replacement system to ensure the technical stability of customer software and the clearing & settlement facility
- > It will comprise of accreditation scenarios that are both unassisted and assisted

# S.3 – Software provider readiness

## Technical accreditation

### How will this phase of testing be run? (cont.)

- > Software providers will be required to submit an accreditation form specifying what CHES User types will be tested and when
- > Once Software providers have run through all planned scenarios, ASX will have the ability to technically verify that accreditation scenarios have completed successfully using accreditation monitoring software

### External Entry Criteria

- > Software providers will be required to have completed all system testing to prove solutions meet functional and non functional requirements

### Critical Success Factors

- > All technical accreditation scenarios have been validated by CTS using the accreditation monitoring software



# Section 4 – CHESS User Readiness

# S.4 - CHES User Readiness

## Overview

- > CHES User Readiness is a stage where CHES users will be required to complete their testing to demonstrate readiness for Go Live of CHES replacement
- > CHES user readiness testing can be categorised by four phases:
  1. CHES user testing, including performance testing
  2. Inflight migration testing
  3. Operational readiness
  4. Industry wide testing

**CHES users** refers to all production users of CHES that plan to be an active users of CHES replacement, including clearing & settlement participants, settlement only participants, account participants, PISPs, registries, specialist settlement participants, payment providers and AMOs

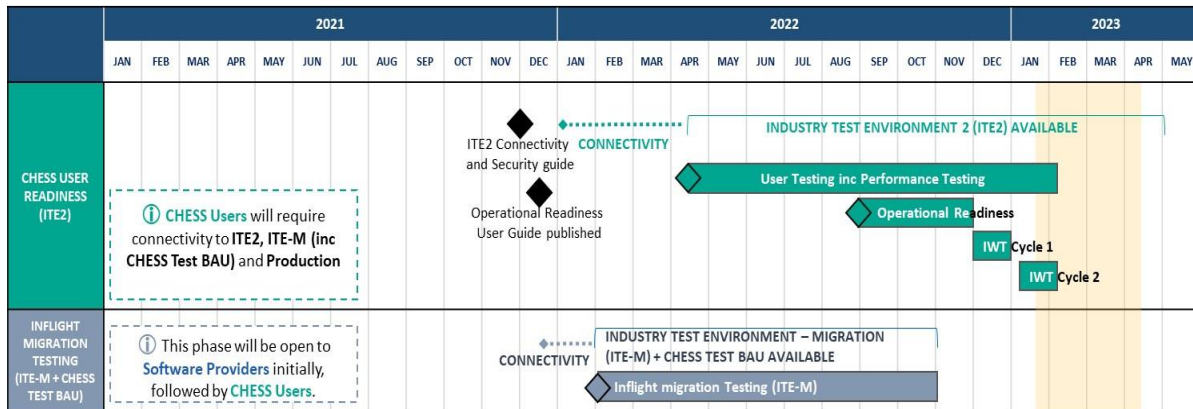

# S.4 - CHES User Readiness

## CHES user testing

### Purpose

- > Allows CHES users to undertake testing on newly delivered software interacting with the CHES replacement system
- > It will enable CHES users to become familiar with operational processes and any functionality changes which have been introduced
- > Designed for the CHES users to undertake sufficient testing in preparation for their readiness assessment, which will take place during the operational readiness phase

### Where will CHES User Testing be conducted?

- > All functional and non-functional CHES user testing will be performed in the ITE2 environment

### How will this phase of testing be run?

- > ASX will operate ITE2 much like production, with similar start and close times and equivalent standard daily activities (e.g. settlement batch)
- > ASX will publish a schedule of events across a range of securities (new listing, corporate actions etc) to provide CHES users the opportunity to participate in a variety of production like scenarios

# S.4 - CHES User Readiness

## CHES user testing

### How will this phase of testing be run? (cont.)

- > ITE2 will provide the ability to test end to end business flows in an integrated environment. CHES Users may also use the available client test tools to achieve their own test outcomes
- > ASX will publish test scenarios per user type, which will be assessed during the operational readiness phase
  - The scenarios will set the minimum range of testing expected during CHES user testing, ahead of each user's readiness assessment
- > CHES users will have the ability to run performance tests & ensure their software handles critical failure scenarios
- > ASX will provide ongoing customer support for functional and non-functional queries through a dedicated CHES replacement email and phone line operating standard business hours

### External Entry Criteria

- > CHES users will be required to have prepared their own test scripts to execute during CHES user testing

### Critical Success Factors

- > Successful completion of CHES user test cases and preparation for readiness assessment in the operational readiness phase

# S.4 - CHES User Readiness

## Operational readiness

### Purpose

- > Operational readiness provides assurance to ASX that CHES users are ready to complete their business operations on CHES replacement for go-live and beyond
  - At completion of this test phase, all CHES users will have successfully demonstrated their end-to-end business flows using accredited software
- > ASX will work closely with CHES users to observe evidence that each organization has sufficient processes in place for all BAU functions that they may perform

### Where will Operational Readiness be conducted?

- > Operational readiness will be assessed in ITE2. It will be scheduled with each CHES user following their user testing

### How will this phase of testing be run?

- > Operational readiness is a mandatory phase where all CHES users will perform specific operational readiness business workflow scenarios, which will be reviewed and assessed by ASX

# S.4 - CHES User Readiness

## Operational readiness

### How will this phase of testing be run? (cont.)

- > Operational readiness scenarios will cover the minimum range of actions that each CHES user group will perform in CHES to complete their business activities
- > Each CHES user will be allocated an assessment window where formal scenario testing will take place to be observed and assessed by ASX
  - Scenarios may have a requirement to produce evidence to demonstrate adequate processes are in place to support each business workflow
- > ASX will continue to operate ITE2 in the same manner as CHES user testing phase, with a published schedule to replicate a variety of production scenarios
- > ASX will continue to provide ongoing customer support for functional/non-functional queries

# S.4 - CHES User Readiness

## Operational readiness

### External Entry Criteria

- > CHES users will be required to have successfully completed user testing during the CHES user testing phase
  - This will include completion of the operational readiness scenarios in advance of an assessment by ASX Operations and Participants Compliance
- > Operational readiness must be conducted on accredited software

### Critical Success Factors

- > Successful completion of all operational readiness scenarios (evidenced) for their CHES user type

# S.4 - CHES User Readiness

## Industry Wide Testing

### Purpose

- > The primary purpose of industry wide testing (IWT) is to provide the final opportunity for CHES users to participate in a simulated, production-like environment
  - It will provide CHES users the ability to perform their business related functions with appropriate counterparties
- > The goal of IWT is to provide CHES users confidence that they, their counterparties and ASX are ready for go live in a production-like environment

### Where will Industry Wide Testing be conducted?

- > IWT will take place in ITE2, following the operational readiness phase

### How will this phase of testing be run?

- > At least two cycles will be run during the IWT phase, which will allow CHES users to have multiple opportunities to participate and transact with their production counterparts
- > IWT will be mandatory for all CHES users and will provide the opportunity to perform a “day in the life of” activities covering all clearing and settlements functions



# S.4 - CHES User Readiness

## Industry Wide Testing

### How will this phase of testing be run? (cont.)

- > ASX will assist in coordinating counterparties and will publish scheduled market events, including batch settlement, corporate action events and exception handling

### External Entry Criteria

- > CHES users will be required to have successfully completed their readiness assessment during the operational readiness phase

### Critical Success Factors

- > CHES users will be required to provide sign-off on each IWT cycle they participate in to prove that they are confident they can perform their business functions in a post go live environment
- > CHES users will need to attest that at least one cycle of IWT was successful

# S.4 - CHES User Readiness

## Attestation

### Purpose

- > Attestation is the final confirmation from all CHES users that they are technically and operationally ready for go-live
  - CHES users must attest that they have completed all of ASX documented phases in order to exit this phase
  - The attestation must be signed off by an authorised CHES user representative and provided to ASX following the final migration dress rehearsal

### **CHES users will be required to attest that they have:**

- > Performed their end-to-end business flows on accredited software
- > Completed CHES user testing
- > Successfully achieved their readiness assessment during operational readiness
- > Successfully completed at least 1 cycle of IWT
- > Participated in market dress rehearsals (to the minimum requirements)

# Section 5 – Industry test environments

# S.5 - Industry test environments

## Why ITE1 and ITE2?

### **ASX is providing two key environments for the next phase of the CHES replacement project**

- > ITE1 is available to software providers – those developing software that interfaces directly to the CHES system
  - This environment supersedes the CDE environments and brings developers into a common and shared environment
- > ITE2 is available to CHES users to test against their own business processes, using software provided by their respective software provider (either a vendor or in-house)

### **Rationale for two environments**

- > To enable software providers the ability to test new software upgrades in advance of CHES users
- > To ensure a well understood software release cycle, with new code being deployed into a system test (ITE1) environment followed by a business testing (ITE2) environment
- > To enable upgrades with breaking changes (for example new schema) to be tested by software providers first and then rolled out to CHES users when proven stable.

# S.5 - Industry test environments

## Technical Characteristics of the Industry Test Environments

- > ITE1 and ITE2 share the same technical characteristics and will be provided on production grade infrastructure:
    - Single dedicated shared environment
    - Availability of CHES user interface (UI)
    - Production style authentication model
    - Third party certificate signing authority
    - Multi-site/multi-node topology across ASX's data centre
    - Ability to test with other CHES users (ITE2 only)
    - Integrated systems to better reflect production state (ITE2)
  - > ITE-M is a low spec environment that will be used to support inflight migration testing, or test scenarios relating to workflows inflight at the point of migration
  - > A CHES test BAU environment will also be stood up as a source environment to capture transactions that will be migrated into ITE-M to validate inflight scenarios
- ITE1 will be available to software providers
  - ITE2 will be available to CHES users
  - ITE-M will be available to only software providers initially, followed by CHES users

# Section 6 – Documentation release plan

## S.6 – Documentation release plan

### Software provider readiness support documentation, entry & exit timelines

Document	Purpose of Document	Target Date for External Publication
<b>Connectivity Guide</b>	Details the technical connectivity requirements for customers to connect to CHES replacement system across all Industry Test Environments	End-July 2021 for ITE1 content
		End-September 2021 for ITE-M content
<b>Security Guide [for ITE1]</b>	Details of security settings to access ITE1 and ITE-M will be provided directly to each organisation as they connect to each environment.	Issued directly to each organisation upon application to access one of the testing environments.
<b>Failover and Recovery Guide</b>	Information relating to failover testing, what components will fail and proposed frequency.	End August 2021
<b>Guide to Testing Services</b>	Relevant for all phases of Industry Testing. Provides software providers all necessary information on the relevant phases of Industry Testing in order for organisations to plan and operate ITE1 and ITE-M.	End August 2021 for software provider phases
		End November 2021 for performance testing and Inflight Migration chapters
<b>CHES UI User Guide</b>	This documentation provides details on the new features, business functionality available when using the new CHES User Interface browser.	End September 2021
<b>Accreditation Guide</b>	Provides an overview of the CHES Replacement technical accreditation test phase and sets expectations regarding conduct and expected results.	End November 2021

## S.6 – Documentation release plan

### CHES user readiness support documentation, entry & exit timelines

Document	Purpose of Document	Target Date for External Publication
<b>Updated Connectivity Guide [to include ITE2]</b>	Details the technical connectivity requirements for customers to connect to CHES replacement system across all Industry Test Environments	End of September 2021
<b>Security Guide [for ITE2]</b>	Details of security settings to access ITE2 will be provided directly to each organisation as they connect to each environment.	Issued directly to each organisation upon application to access one of the testing environments.
<b>CHES UI User Guide</b>	This documentation provides details on the new features, business functionality available when using the new CHES User Interface browser.	CHES UI connectivity information is already published <a href="#">here</a> . The CHES UI User Guide is scheduled to be fully complete by the end of September 2021
<b>ASX Procedures and Guidelines (APGs)</b>	Provides operational guidelines for all CHES User types (clearing & settlement, sponsorship participants, issuer (registries) and payment providers). CHES Users can use these guidelines as a base for establishing internal procedures that suit their business and processing systems.	Most of the APG has already been <a href="#">published</a> . It is scheduled to be fully complete by the end of December 2021.
<b>Operational Readiness Scenarios</b>	Outlines operational readiness scenarios for each CHES user type including success criteria.	End of December 2021



## S.6 – Documentation release plan

### CHES user readiness support documentation, entry & exit timelines

Document	Purpose of Document	Target Date for External Publication
<b>Updated Guide to Testing Services [to include ITE2]</b>	Relevant for all phases of Industry Testing.  Provides CHES users all necessary information on relevant phases of Industry Testing in order for organisations to plan and operate ITE1 and ITE-M.	End of January 2022
<b>Updated Failover and Recovery Guide [to include ITE2]</b>	Information relating to failover testing, what components will fail and a proposed frequency. Further details on failover and recovery, to the Guide to Testing Services, if required.	End of January 2022
<b>User Guide</b>	Provides detailed information around how to operate within the environment through each phase of ITE2 - CHES User Testing, Operational Readiness and IWT	End of January 2022
<b>Industry Wide Testing (IWT) Information Pack</b>	Provides detailed information around the scope of each IWT cycle and detailed plan.	End of September 2022

# Section 7 – Summary of industry testing

# S.7 – Summary of industry testing

## Software provider readiness

To assist software providers, a summarised reference guide has been provided in section 7.

Stage	Phase	Environment	Relevant Party/s	Entry Criteria	Exit Criteria	Optional/ Mandatory	Relevant Subsequent Documentation
Software Provider Readiness	System Testing	ITE1	Software Providers	Software providers should ensure that they are appropriately prepared and have internally tested their software prior to entering the system testing phase.	Successful completion of all technical accreditation tests.	Mandatory	<ul style="list-style-type: none"><li>• Connectivity Guide</li><li>• Security Guide</li><li>• Guide to Testing Services</li><li>• Failover and Recovery Guide</li><li>• CHES UI User Guide</li></ul>
	Inflight Migration Testing	ITE-M	Software Providers	Software providers will need to have functionally tested their core functions in ITE1, prior to testing the relevant workflows for data migration migration in ITE-M.	Software providers should have successfully demonstrated they have achieved their internal test plans for pre-defined migration scenarios.	Optional	<ul style="list-style-type: none"><li>• Connectivity Guide</li><li>• Security Guide</li><li>• Guide to Testing Services</li></ul>
	Technical Accreditation	ITE1	Software Providers	Software providers to have run all technical accreditation scenarios successfully during system testing.	The software providers must demonstrate to ASX's satisfaction that all mandatory technical accreditation scenarios have passed the success criteria.	Mandatory	Accreditation Guide

# S.7 – Summary of industry testing

## CHES user readiness

To assist CHES users, a summarised reference guide has been provided in section 7.

Stage	Phase	Environment	Relevant Party/s	Entry Criteria	Exit Criteria	Optional/ Mandatory	Relevant Subsequent Documentation
CHES User Readiness	CHES User Testing	ITE2	CHES User	<ul style="list-style-type: none"><li>• CHES users to have completed ITE2 Connectivity;</li><li>• CHES users to have been onboarded successfully into ITE2;</li><li>• CHES users have prepared their own test scripts to execute during User Testing, using operational readiness scenarios as minimum criteria;</li><li>• CHES users have appointed primary technical and operational contacts for ASX to work with during ITE2 activities (user testing &amp; operational readiness); and</li><li>• if participating in performance testing, CHES users have prepared their own test scripts to execute during Performance Testing.</li></ul>	Successful completion of their own test scripts including the minimum requirements (operational readiness scenarios) set by ASX.	Mandatory	<ul style="list-style-type: none"><li>• Updated Connectivity Guide</li><li>• Security Guide</li><li>• Updated Guide to Testing Services</li><li>• Updated Failover and Recovery Guide</li><li>• User Testing User Guide</li><li>• Operational Readiness Scenarios</li><li>• CHES UI User Guide</li></ul>
	Inflight Migration Testing	ITE-M	CHES Users	CHES users will need to have functionally tested their core functions in ITE2, prior to testing the relevant workflows for data migration migration in ITE-M.	Successful completion of the CHES users' migration scenarios.	Optional	<ul style="list-style-type: none"><li>• Connectivity Guide</li><li>• Security Guide</li><li>• Guide to Testing Services</li></ul>

Q&A

Next steps

# Next steps

## Review and feedback:

- > Webinar recording, slides and Q&A will be published on the CHES Replacement webpage
- > Provide feedback by contacting [CHESReplacement@asx.com.au](mailto:CHESReplacement@asx.com.au) – use “I&T webinar” as the subject heading
- > Feedback welcome by COB Wednesday, 14 July ‘21

## Next I&T Working Group meeting:

- > Date: Wednesday 28 July ‘21

Thank you.





# Disclaimer

*This document provides general information only. ASX Limited (ABN 98 008 624 691) and its related bodies corporate (“ASX”) makes no representation or warranty with respect to the accuracy, reliability or completeness of the information. To the extent permitted by law, ASX and its employees, officers and contractors shall not be liable for any loss or damage arising in any way (including by way of negligence) from or in connection with any information provided or omitted or from anyone acting or refraining to act in reliance on this information.*

*© 2021 ASX Limited ABN 98 008 624 691*